

RYCHLOSPOJKY

> METRICKÝ SYSTÉM

PHF průtokové oko
s vnitřním závitem

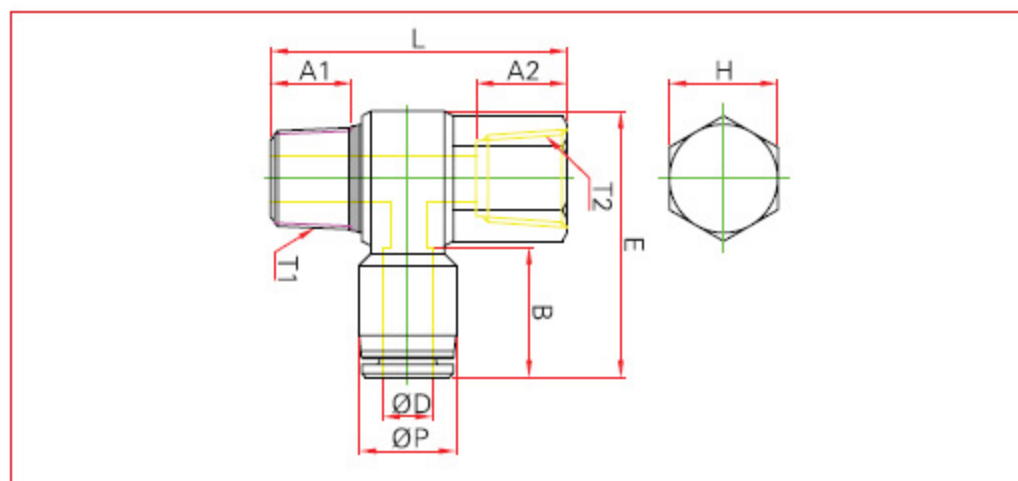

TYP	ØD	ØP	T1	T2	L	E	A1	A2	B	H (6-ti hran)	PRŮTOK
PHF04-M5	4	11	M5×P0.8	M5×P0.8	20.0	25.1	3.6	7.0	15	8	1.5
PHF04-M6	4	11	M6×P1.0	M6×P1.0	25.0	30.5	4.1	7.0	15	11	2.0
PHF04-01	4	11	PT1/8	PT1/8	30.2	30.5	8.0	8.0	15	14	3.0
PHF04-02	4	11	PT1/4	PT1/4	35.5	34.5	10.0	10.0	15	17	3.2
PHF06-M5	6	13	M5×P0.8	M5×P0.8	20.0	27.8	3.6	7.0	15	8	1.5
PHF06-M6	6	13	M6×P1.0	M6×P1.0	25.0	31.2	4.1	7.0	15	11	2.0
PHF06-01	6	13	PT1/8	PT1/8	30.2	31.2	8.0	8.0	15	14	3.0
PHF06-02	6	13	PT1/4	PT1/4	35.5	35.0	10.0	10.0	15	17	4.0
PHF06-03	6	13	PT3/8	PT3/8	41.2	38.7	11.0	11.0	15	21	5.0
PHF06-04	6	13	PT1/2	PT1/2	50.0	44.9	14.0	14.0	15	24	5.0
PHF08-01	8	14.4	PT1/8	PT1/8	30.2	33.0	8.0	8.0	18	14	3.0
PHF08-02	8	14.4	PT1/4	PT1/4	35.5	36.8	10.0	10.0	18	17	4.0
PHF08-03	8	14.4	PT3/8	PT3/8	41.2	40.1	11.0	11.0	18	21	5.0
PHF08-04	8	14.4	PT1/2	PT1/2	50.0	45.8	14.0	14.0	18	24	6.0
PHF10-01	10	18.4	PT1/8	PT1/8	30.2	35.0	8.0	8.0	22	14	3.0
PHF10-02	10	18.4	PT1/4	PT1/4	35.5	38.0	10.0	10.0	22	17	4.0
PHF10-03	10	18.4	PT3/8	PT3/8	41.2	42.2	11.0	11.0	22	21	5.0
PHF10-04	10	18.4	PT1/2	PT1/2	50.0	47.5	14.0	14.0	22	24	6.0
PHF12-02	12	21	PT1/4	PT1/4	35.5	40.8	10.0	10.0	22	17	4.0
PHF12-03	12	21	PT3/8	PT3/8	41.2	45.9	11.0	11.0	22	21	5.0
PHF12-04	12	21	PT1/2	PT1/2	50.0	50.1	14.0	14.0	22	24	6.0