

RACCORDI AUTOMATICI ALTA PRESSIONE

HIGH PRESSURE PUSH-IN FITTINGS

STECKVERSCHRAUBUNGEN FÜR HOCHDRUCK

RACCORDS INSTANTANÉS HAUTE PRESSION

RACORDAJE AUTOMÁTICO PARA ALTA PRESIÓN

CONEXÕES PUSH-IN PARA ALTA PRESSÃO

Serie 58000





CARATTERISTICHE TECNICHE
 TECHNICAL CHARACTERISTICS
 TECHNISCHE ANGABEN
 CARACTÉRISTIQUES TECHNIQUES
 CARACTERÍSTICAS TÉCNICAS
 CARACTERÍSTICAS TÉCNICAS



Norma di Riferimento
 Reference standard
 Entspricht der Norm
 Norme de référence
 Normativa de referencia
 Norma de referência

1907/2006

REACH

2011/65/CE



PED
2014/68/UE

SILICON
FREE

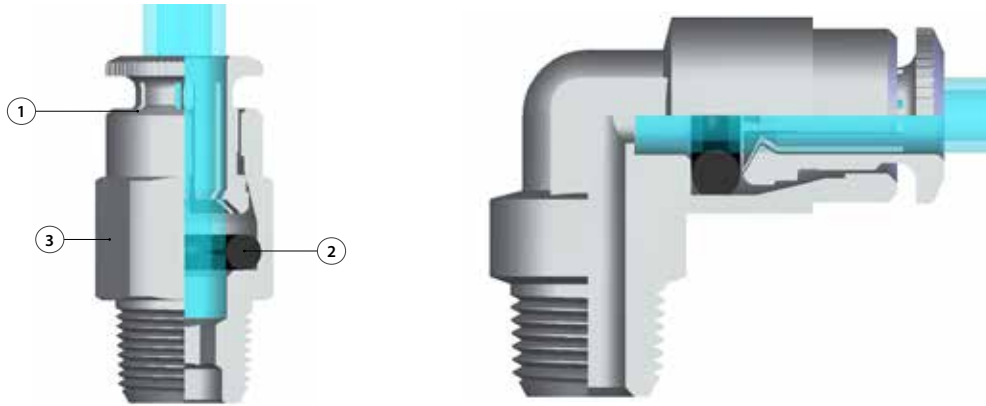

| Materiali e Componenti | IT | Component Parts and Materials | GB | Komponenten und Materialien | DE |
|--|----|--|----|--|----|
| 1 Pinza in Ottone nichelato 2 Guarnizione O-Ring in HNBR 3 Corpo in Ottone nichelato | | 1 Nickel-plated Brass Collet 2 HNBR O-RING Seal 3 Nickel-plated Brass Body | | 1 Zange Messing vernickelt 2 O-Ring HNBR 3 Körper Messing vernickelt | |
| Matériaux et Composants | FR | Materiales y Componentes | ES | Materiais e Componentes | PT |
| 1 Pousoir: Laiton nickelé 2 Joint torique: HNBR 3 Corps: Laiton nickelé | | 1 Pinza en latón niquelado 2 Junta tórica O-Ring en HNBR 3 Cuerpo en latón niquelado | | 1 Pinça em Latão Niquelado 2 Vedação O-Ring em HNBR 3 Corpo em Latão Niquelado | |



Temperature

Temperatures
 Temperatur
 Températures
 Temperaturas
 Temperaturas

- 30 °C
 + 150 °C



Pressione minima
 Minimum pressure
 Druck minimum
 Pression minimale
 Presión mínima
 Pressão mínima

0 bar (0 MPa)

Pressione massima con fluidi
 Maximum pressure with fluids
 Druck maximum mit Flüssigkeiten
 Pression maximale avec fluides
 Presión máxima con fluidos
 Pressão máxima con fluidi

150 bar (15 MPa)

Pressione massima con aria
 Maximum pressure with air
 Druck maximum mit Luft
 Pression maximale avec air
 Presión máxima con aire
 Pressão máxima com ar

*** 30 bar (3 MPa)**



Fluidi compatibili

Olio / Acqua / Grasso

Fluids

Oil / Water / Grease

Geeignete Medien

Oel / Wasser / Fett

Fluides compatibles

Huile / Eau / Graisse

Fluidos compatibles

Aceite / Agua / Grasa

Fluidos compatíveis

Óleo / Água / Graxa



| Tubi di Collegamento | IT | Connection Tubes | GB | Geeignete Rohre | DE |
|---|----|---|----|--|----|
| Tubi in materiale plastico: PA6, PA66 per Alta Pressione. * PA6, PA66, PA11, PA12, Polietilene, Poliuretano, FEP, PTFE. | | Plastic tubes: PA6, PA66 for High Pressure. * PA6, PA66, PA11, PA12, Polyethylene, Polyurethane, PEF, PTFE. | | Kunststoffrohre: PA6, PA66 für Hochdruck. * PA6, PA66, PA11, PA12, Polyethylen, Polyurethan, FEP, PTFE. | |
| Tubes Conseillés | FR | Tubos de Conexión | ES | Tubos de Conexão | PT |
| Tubes plastiques: PA6, PA66 pour Haute Pression. * PA6, PA66, PA11, PA12, Polyéthylène, Polyuréthane, PEF, PTFE. | | Tubos en material plástico: PA6, PA66 per Alta Presión. * PA6, PA66, PA11, PA12, Polietileno, Poliuretano, PEF, PTFE. | | Tubos em material plástico: PA6, PA66 para Alta Pressione. * PA6, PA66, PA11, PA12, Polietileno, Poliuretano, PEF, PTFE. | |



| Filettatura | IT | Threads | GB | Gewindearten | DE |
|--|----|---|----|---|----|
| Gas conica conforme ISO 7.1, BS 21, DIN 2999. Metrica conica conforme UNI 7707. | | Tapered gas in conformity with ISO 7.1, BS 21, DIN 2999. Metric Tapered in conformity with UNI 7707. | | Konisches Gewinde nach Norm ISO 7.1, BS 21, DIN 2999. Metrisches konisches Gewinde nach Norm UNI 7707. | |
| Filetages | FR | Roscas | ES | Roscas | PT |
| Filetage conique conforme: ISO 7.1, BS 21, DIN 2999. Filetage métrique conforme UNI 7707. | | Gas cónica conforme ISO 7.1, BS 21, DIN 2999. Métrica cónica conforme UNI 7707. | | Gas cónica conforme ISO 7.1, BS 21, DIN 2999. Métrica cónica conforme UNI 7707. | |

58000

New

RACCORDO DIRITTO MASCHIO CONICO

STRAIGHT MALE ADAPTOR (TAPER)
GERADE EINSCHRAUBVERSCHRAUBUNG KONISCH
RACCORD DROIT MÂLE, CONIQUE
RACOR RECTO MACHO CÔNICO
CONEXÃO RETA COM ROSCA MACHO CÔNICA

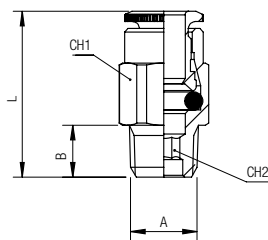

| Code | Tube | A | B | L | CH1 | CH2 | Pack. |
|--------------|------|---------|-----|------|-----|-----|-------|
| 58000 00 010 | 4 | M6x0.75 | 6 | 22 | 10 | 2.5 | 10 |
| 58000 00 001 | 4 | M6x1 | 6 | 22 | 10 | 2.5 | 10 |
| 58000 00 002 | 4 | M8x1 | 6 | 20 | 10 | 3 | 10 |
| 58000 00 013 | 4 | M8x1.25 | 7 | 23 | 10 | 3 | 10 |
| 58000 00 003 | 4 | M10x1 | 6.5 | 20 | 10 | 3 | 10 |
| 58000 00 015 | 4 | M10x1.5 | 7.5 | 22.5 | 10 | 3 | 10 |
| 58000 00 004 | 4 | 1/8 | 7.5 | 21 | 10 | 3 | 10 |
| 58000 00 012 | 4 | 1/4 | 11 | 26 | 14 | 3 | 10 |
| 58000 00 011 | 6 | M6x0.75 | 6 | 24.5 | 12 | 2.5 | 10 |
| 58000 00 005 | 6 | M6x1 | 6 | 24.5 | 12 | 2.5 | 10 |
| 58000 00 006 | 6 | M8x1 | 6 | 24.5 | 12 | 3 | 10 |
| 58000 00 016 | 6 | M8x1.25 | 7 | 26 | 12 | 3 | 10 |
| 58000 00 007 | 6 | M10x1 | 6.5 | 21.5 | 12 | 3 | 10 |
| 58000 00 017 | 6 | M10x1.5 | 7.5 | 25 | 12 | 4 | 10 |
| 58000 00 008 | 6 | 1/8 | 7.5 | 23 | 12 | 3 | 10 |
| 58000 00 009 | 6 | 1/4 | 11 | 26.5 | 14 | 4 | 10 |

58040

RACCORDO DIRITTO INTERMEDIO

STRAIGHT CONNECTOR
VERBINDUNGSVERSCHRAUBUNG
RACCORD UNION DOUBLE
RACOR RECTO INTERMEDIO
CONEXÃO RETA TUBO-TUBO

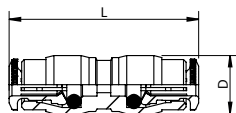

| Code | Tube | L | D | Pack. |
|--------------|------|----|----|-------|
| 58040 00 001 | 4 | 35 | 11 | 10 |
| 58040 00 002 | 6 | 37 | 13 | 10 |

58080

New

RACCORDO DIRITTO MASCHIO CILINDRICO CON VALVOLA UNIDIREZIONALE

NON-RETURN - PUSH-IN - PARALLEL THREAD
RÜCKSCHLAVENTILE - DURCHFLUSS VOM STECKANSCHLUSS ZU ZYLINDRISCHEM AUSSENGEWINDE
CLAPET ANTI-RETOUR - CONNEXION INSANTANEE - FILETAGE MALE
VALVOLA UNIDIREZIONALE - TUBO - ROSCA MACHO
VALVULA ANTI-RETORNO - CONEXOES PUSH-IN - ROSCA MACHO

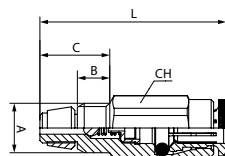

| Code | Tube | A | B | L | C | CH | Pack. |
|--------------|------|-------|-----|------|----|----|-------|
| 58080 00 001 | 4 | M10x1 | 6.5 | 37 | 14 | 10 | 10 |
| 58080 00 002 | 6 | M10x1 | 6.5 | 37.5 | 14 | 12 | 10 |



Fluidi compatibili
Fluids
Geeignete Medien
Fluides compatibles
Fluidos compatibles
Fluidos compatíveis

Solo Grasso
Only Grease
Nur Fett
Juste Graisse
Solo Grasa
Solo Graxa