

# Elbow 90 Equal Banded F/F

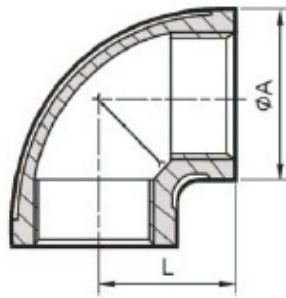

Unit: mm

SIZE	φA	L
1/8"	15.5	17.5
1/4"	19.0	19.5
3/8"	22.5	23.5
1/2"	27.5	27.5
3/4"	33.0	32.5
1"	40.5	38.5
1-1/4"	50.0	45.5
1-1/2"	56.5	48.5
2"	70.0	57.5
2-1/2"	86.5	69.5
3"	100.0	78.5
4"	126.0	96.5

**Materials:** ASTM A351, CF8M, CF8

**Threads:** ANSI B1.20.1 (NPT), BS 21 (PT, BSP), ISO 7/1, ISO 228/1

**Dimensions:** ISO 4144

**Rating:** 150 PSI on Fittings

**Superior Quality:**

- Fittings are thread-tested in the strict manufacturing processes prior to shipment.
- Pneumatic Pressure Testing is performed.
- Before pouring, each material batch is carefully analyzed by Spectrometer for Chemical Composition and Analysis
- Unions are completely interchangeable.
- Internal burrs are carefully removed to prevent seal damage and leakage.

## CHEMICAL REQUIREMENT

Element%	Type	304	316	CF8	CF8M
C		0.08 Max	0.08 Max	0.08 Max	0.08 Max
Si		1.00 Max	1.00 Max	2.00 Max	1.50 Max
Mn		2.00 Max	2.00 Max	1.50 Max	1.50 Max
P		0.045 Max	0.045 Max	0.040 Max	0.040 Max
S		0.03 Max	0.03 Max	0.040 Max	0.040 Max
Ni		8.0 ~ 10.5	10.0 ~ 14.0	8.0 ~ 11.0	9.0 ~ 12.0
Cr		18.0 ~ 20.0	16.0 ~ 18.0	18.0 ~ 21.0	18.0 ~ 21.0
Mo		—	2.0 ~ 3.0	0.5 Max	2.0 ~ 3.0

## TENSILE REQUIREMENT

Testing Item	Type	304 & CF8	316 & CF8M
Tensile Strength Ksi (MPa)		70 (485) Min	70 (485) Min
Yield Strength Ksi (MPa)		30 (205) Min	30 (205) Min
Elongation in 2" or 50mm%		35.0Min	30.0Min

## DIMENTIONAL TOLERANCE

Unit:mm

Size	≤ 30	30-50	50-75	75-100	100-150	150-200	200-300	≥ 300
Tolerance	± 0.9	± 1.0	± 1.1	± 1.2	± 1.4	± 1.5	± 1.8	± 2.0