

ITALIENISCHES- / BAZZOLI-SIEGPERLE-SYSTEM

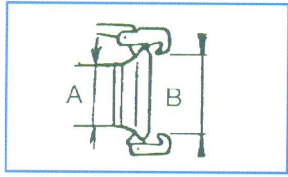

**MT-KUPPLUNG ZUM
ANSCHWEIßEN**

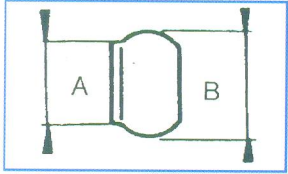

KUGEL ZUM ANSCHWEIßEN

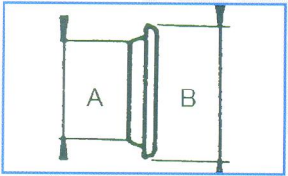

RING FÜR KUGEL

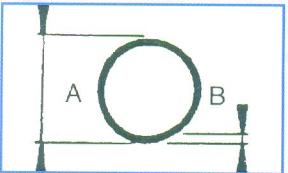

O-RING

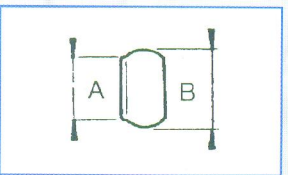

SYSTEM „BAUER“

KUGEL ZUM ANSCHWEIßEN

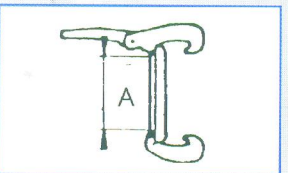

HEBELVERSCHLUßRING

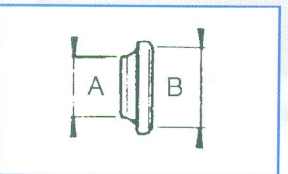

**V-KUPPLUNG ZUM
ANSCHWEIßEN**

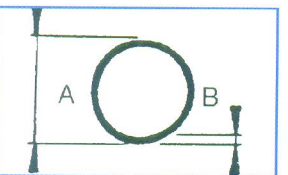

O-RING

NW	innen A	außen	B
80	70	74	110
100	89	94	132
108	105	110	140
120	112	118	151
150	139	146	180
200	197	205	245
150 Bazzoli	139	144	188
80	70	74	111
100	89	94	130
108	105	110	140
120	112	118	150
150	139	146	180
200	197	205	243
150 Bazzoli	139	144	186
80	96	-	136
100	89	-	165
108	105	-	180
120	112	-	185
150	139	-	225
200	197	-	290
150 Bazzoli	176	-	233
80	-	125	11
100	-	148	12
108	-	155	12
120	-	170	15
150	-	205	15
200	-	270	18
150 Bazzoli	-	212	15

50	49	74	70
76	76	94	98
89	89	94	120
108	107	110	145
133	132	118	159
159	156	146	179
194	192	205	230
50	62	-	111
76	89	-	-
89	113	-	-
108	133	-	-
133	150	-	-
159	170	-	-
194	248	-	-
50	49	52	71
76	76	79	99
89	89	92	121
108	107	112	148
133	132	138	163
159	156	163	182
194	192	188	231
50	-	83	9
76	-	115	13
89	-	134	14
108	-	160	15
133	-	190	18
159	-	208	19
194	-	253	18

PERROT-SYSTEM

KARDAN-BECHER ZUM ANSCHWEIßEN

NW	A	B
50	50	74,5
70	70	98,5
89	89	126,0
108	108	145,5
133	133	171,5
159	159	203,5
216	216	287,0

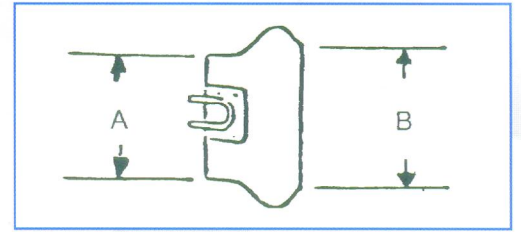

V-TEIL ZUM ANSCHWEIßEN

50	50	75,0
70	70	102,5
89	89	134,0
108	108	155,5
133	133	179,0
159	159	211,0
216	216	312,5

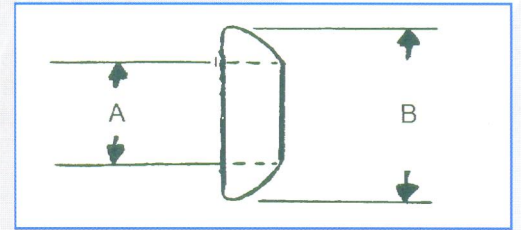

M-TEIL MIT AUßENGEWINDE

50 x 1 1/2"	48,3	74,5
50 x 2"	60,3	74,5
70 x 2 1/2"	76,1	98,5
89 x 2 1/2"	76,1	126,5
89 x 3"	88,9	126,5
108 x 4"	114,3	145,5
133 x 5"	139,7	171,5
159 x 6"	165,1	203,5

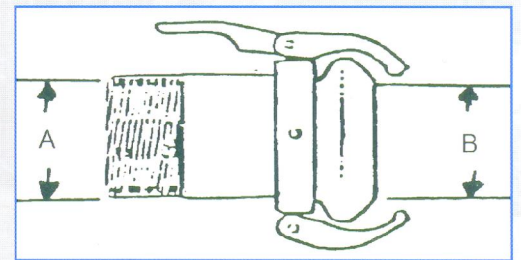

V-TEIL MIT AUßENGEWINDE

50 x 1 1/2"	48,3	50,0
50 x 2"	60,3	50,0
70 x 2 1/2"	76,1	70,0
89 x 2 1/2"	76,1	89,0
89 x 3"	88,9	89,0
108 x 4"	114,3	108,0
133 x 5"	139,7	133,0
159 x 6"	165,1	159,0

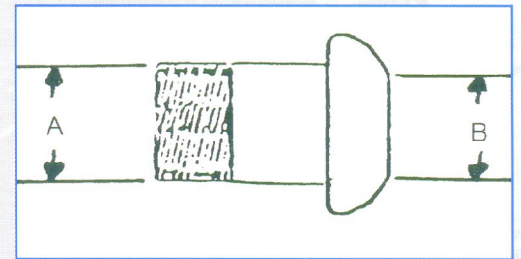

O-RING

50	87,0	11,0
70	108,5	11,5
89	139,0	14,0
108	160,0	18,0
133	190,0	20,0
133	190,0	22,0
159	222,0	20,0
159	222,0	22,0
216	306,0	25,0

