

CAM & GROOVE WELDING COUPLINGS

Butt weld vs socket weld

Cam & groove couplings can be welded on hoses, pipes an other welding couplings by using:

- cam & groove couplings with butt weld connection
- cam & groove couplings with socket weld connection

Butt welding

Welding ends with a butt weld connection are used for welding the majority of cam & groove couplings. A butt weld connection consists of a 30° welding end. During the welding process, the butt weld cam & groove coupling is connected to a hose, pipe or coupling by the application of heat and pressure.

Socket welding

In socket welding, the pipe or hose slides partially inside the cam & groove coupling. Both components are then welded together at the point of insertion.

Welding dimensions

The welding dimensions for cam & groove couplings are based on inch / schedule 40 pipe sizes.

ND	INCH	A mm	B mm
15	1/2"	21.34	2.0
20	3/4"	26.67	2.3
25	1"	33.40	2.6
32	1.1/4"	42.16	2.6
40	1.1/2"	48.26	2.6
50	2"	60.33	2.9
65	2.1/2"	76.03	2.9
80	3"	88.90	3.2
100	4"	114.30	3.6
125	5"	139.70	4.0
150	6"	168.28	4.5



Butt weld connection



Socket weld connection

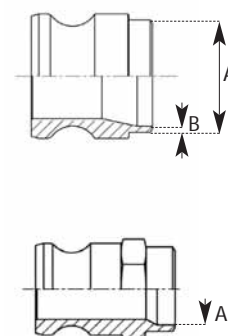

TYPE AWB: ADAPTOR WITH BUTT WELD CONNECTION

ND	Inch	Material	Weight/pc Kg	Reference
15	1/2"	Stainless steel	0.11	VLAWBR013
20	3/4"	Stainless steel	0.16	VLAWBR019
25	1"	Stainless steel	0.26	VLAWBR025
32	1.1/4"	Stainless steel	0.41	VLAWBR032
40	1.1/2"	Stainless steel	0.53	VLAWBR038
50	2"	Stainless steel	0.69	VLAWBR050
65	2.1/2"	Stainless steel	0.96	VLAWBR063
80	3"	Stainless steel	1.38	VLAWBR075
100	4"	Stainless steel	2.04	VLAWBR100
125	5"	Stainless steel	3.52	VLAWBR125
150	6"	Stainless steel	5.14	VLAWBR150



30°

Coupling standard: Federal Mil A-A-59326A
 Welding end: butt weld to schedule 40 pipe size
 Stainless steel: AISI 316 - EN 1.4401

CAM & GROOVE WELDING COUPLINGS

TYPE DWB: COUPLER WITH BUTT WELD CONNECTION

ND	Inch	Material	Weight/pc Kg	Reference
15	1/2"	Stainless steel	0.22	VLDWBR013
20	3/4"	Stainless steel	0.20	VLDWBR019
25	1"	Stainless steel	0.29	VLDWBR025
32	1.1/4"	Stainless steel	0.50	VLDWBR032
40	1.1/2"	Stainless steel	0.54	VLDWBR038
50	2"	Stainless steel	0.67	VLDWBR050
65	2.1/2"	Stainless steel	1.04	VLDWBR063
80	3"	Stainless steel	1.36	VLDWBR075
100	4"	Stainless steel	1.84	VLDWBR100
125	5"	Stainless steel	3.36	VLDWBR125
150	6"	Stainless steel	3.67	VLDWBR150



30°

Coupling standard: Federal Mil A-A-59326A
Welding end: butt weld to schedule 40 pipe size
Stainless steel: AISI 316 - EN 1.4401

TYPE AWS: ADAPTOR WITH SOCKET WELD CONNECTION

ND	Inch	Material	Weight/pc Kg	Reference
15	1/2"	Stainless steel	0.07	VLAWSR013
20	3/4"	Stainless steel	0.11	VLAWSR019
25	1"	Stainless steel	0.15	VLAWSR025
32	1.1/4"	Stainless steel	0.24	VLAWSR032
40	1.1/2"	Stainless steel	0.27	VLAWSR038
50	2"	Stainless steel	0.42	VLAWSR050
65	2.1/2"	Stainless steel	0.71	VLAWSR063
80	3"	Stainless steel	0.73	VLAWSR075
100	4"	Stainless steel	1.42	VLAWSR100
150	6"	Stainless steel	3.17	VLAWSR150



Coupling standard: Federal Mil A-A-59326A
Welding end: socket weld to schedule 40 pipe size
Stainless steel: AISI 316 - EN 1.4401

TYPE DWS: COUPLER WITH SOCKET WELD CONNECTION

ND	Inch	Material	Weight/pc Kg	Reference
15	1/2"	Stainless steel	0.13	VLDWSR013
20	3/4"	Stainless steel	0.23	VLDWSR019
25	1"	Stainless steel	0.36	VLDWSR025
32	1.1/4"	Stainless steel	0.48	VLDWSR032
40	1.1/2"	Stainless steel	0.57	VLDWSR038
50	2"	Stainless steel	0.90	VLDWSR050
65	2.1/2"	Stainless steel	1.03	VLDWSR063
80	3"	Stainless steel	1.23	VLDWSR075
100	4"	Stainless steel	2.30	VLDWSR100
150	6"	Stainless steel	4.42	VLDWSR150



Coupling standard: Federal Mil A-A-59326A
Welding end: socket weld to schedule 40 pipe size
Stainless steel: AISI 316 - EN 1.4401