

Quick Connect Couplings with International Plug Profiles



The **LUDECKE** product range contains a large selection of quick connect couplings with international plug profiles. They cover the world's most common used plug profiles and ensure high compatibility. These coupling systems are available from DN 5 to DN 10 - depending on requested flow rates.

LUDECKE offers quick connect couplings customised to the following countries:

- Great Britain
- Spain
- France
- Benelux countries
- Switzerland
- Asia
- USA
- and others

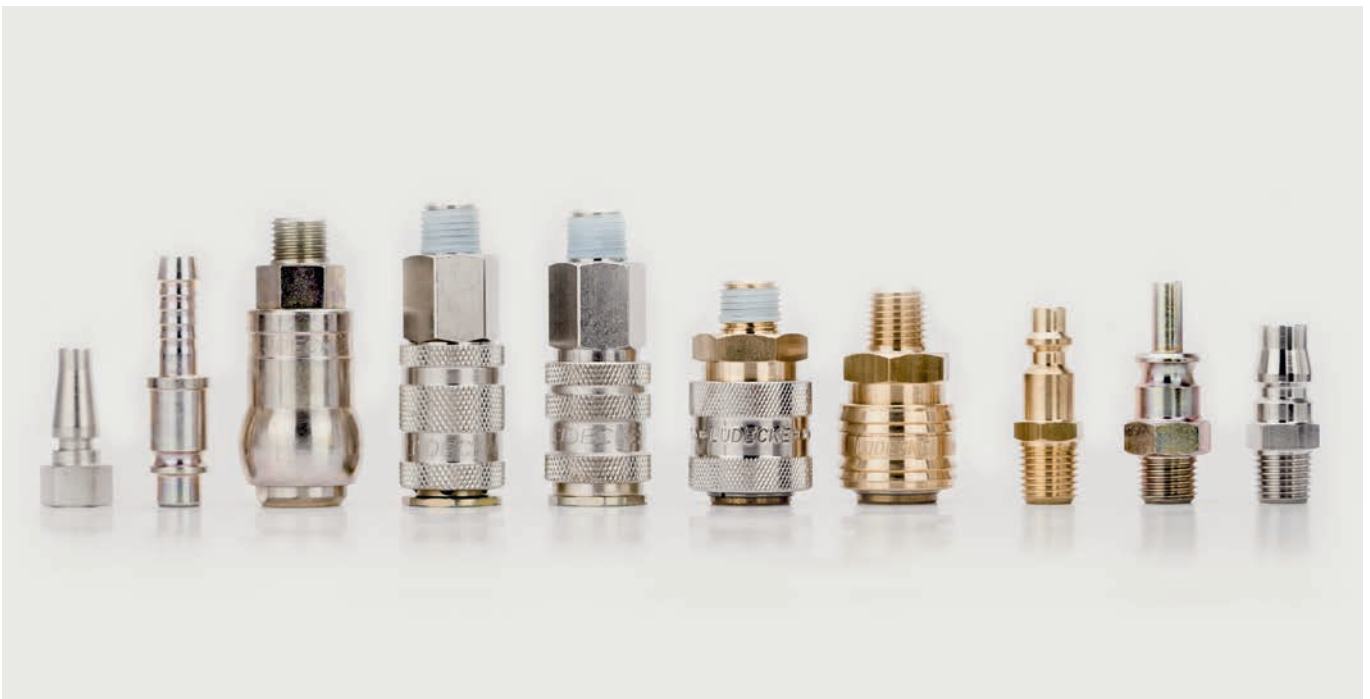

All series are available in different sizes, connection types, valve types and materials.

Different Sizes and Versions

For better understanding, products with international plug profiles are divided into groups according to country compatibility. However, it is also possible to break them down into the series **Quality-**, **OptiFlow-** and **SafeConnect-Line**.



Quality-Line
Standard Quick Connect Couplings
→ In series ESA DN 5.5 / ESO DN 5.5 / ESK DN 7.5 / F1K DN 8

OptiFlow-Line
Energy-Efficient Quick Connect Couplings with patented OptiFlow by **LUDECKE**® Valve Technology
→ In series ESB DN 5.5 / ESBI DN 5 / ESAI DN 5.5 / ESAIS DN 5.5 / ESOI DN 5.5 / ESOIS DN 5.5 / ESAC DN 8 / ESACG DN 10

SafeConnect-Line
Quick Connect Couplings for High-Safety Standards
→ In series ESAIS DN 5.5 / ESOIS DN 5.5

Chart of Flow Rates

The flow rates of the different coupling systems are summarized in the following chart.

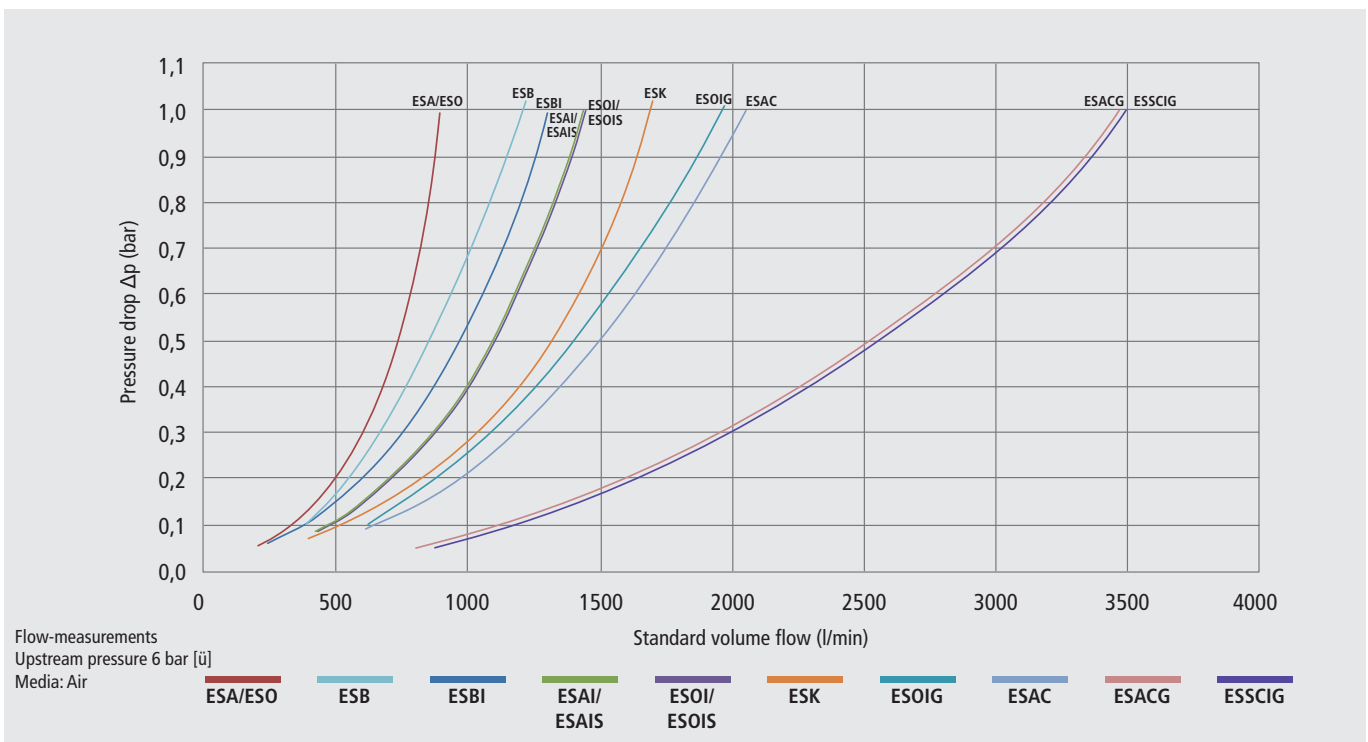

Overview of Quick Connect Couplings with

NEW!

Series **ESB** DN 5.5 **ESBI** DN 5 **ESA** DN 5.5 **ESAI** DN 5.5 **ESAIS** DN 5.5 **ESO** DN 5.5 **ESOI** DN 5.5

Plug Profile
(original size)

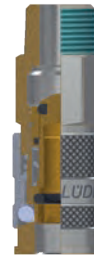
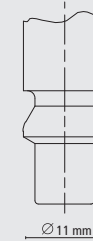
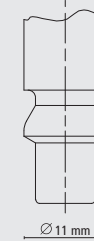
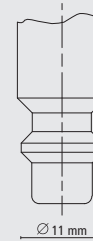
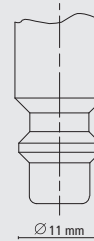
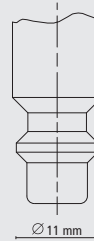
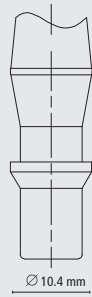

Materials	ESB	ESBI	ESA	ESAI	ESAIS	ESO	ESOI
Body:	MS 58 nickel-plated	MS 58 nickel-pl.	MS 58 plain	MS 58 nickel-pl.	MS 58 nickel-pl.	MS 58 plain	MS 58 nickel-pl.
Sleeve:	Steel hardened + nickel-pl	Steel hardened + nickel-pl.	MS 58 plain	Steel hardened + nickel-pl.	Steel hardened + nickel-pl.	MS 58 plain	Steel hardened + nickel-pl.
Valve body:	MS 58 nickel-plated	Steel hardened + zinc-pl	MS 58 plain	MS 58 nickel-plated	MS 58 nickel-plated	MS 58 plain	MS 58 nickel-plated
Valve:	MS 58 plain	MS 58 plain	MS 58 plain	MS 58 plain	MS 58 plain	MS 58 plain	MS 58 plain
Springs, Retaining ring:	Stainless Steel 1.4310	Stainless Steel 1.4310	Stainless Steel 1.4310	Stainless Steel 1.4310	Stainless Steel 1.4310	Stainless Steel 1.4310	Stainless Steel 1.4310
Balls:	Stainless Steel 1.4034	Stainless Steel 1.4034	-	Stainless Steel 1.4034	Stainless Steel 1.4034	-	Stainless Steel 1.4034
Pins:	-	-	Stainless Steel 1.4305	-	-	Stainless Steel 1.4305	-
Seals:	NBR	NBR	NBR	NBR	NBR	NBR	NBR
Special seals for other media on request:	-	EPDM/ FKM/ FFKM	EPDM/ FKM/ FFKM	EPDM/ FKM/ FFKM	EPDM/ FKM/ FFKM	EPDM/ FKM/ FFKM	EPDM/ FKM/ FFKM
Plug:	Steel hardened + nickel-plated	Steel hardened + nickel-plated	MS 58 plain/ Steel zinc-pl.+ yellow passivated	Steel hardened + nickel-plated	Steel hardened + nickel-plated	MS 58 plain	Steel hardened + nickel-plated
Max. Working Pressure:	PN 35 bar	PN 35 bar	PN 35 bar	PN 35 bar	PN 12 bar	PN 35 bar	PN 35 bar
Temperature:	-20°C – +100°C	-20°C – +100°C	-20°C – +100°C	-20°C – +100°C	-20°C – +100°C	-20°C – +100°C	-20°C – +100°C
Thread type:	ISO 228/ DIN EN 10226	ISO 228/ DIN EN 10226	ISO 228/ NPT	ISO 228/ DIN EN 10226	ISO 228/ DIN EN 10226	ISO 228	ISO 228/ DIN EN 10226
Max. Flow Capacity: at 6 bar (ü) and 0.5 bar Pressure drop Single shut-off	800 l/min	950 l/min	775 l/min	1100 l/min	1100 l/min	775 l/min	1140 l/min
Type of valve:	single	single	single	single	single	single	single
Operation:	One-Hand	One-Hand	One-Hand	One-Hand	One-Hand	One-Hand	One-Hand
Norm:	-	-	ISO 6150 B US-MIL-Spec. C4109 Industr. Interchange 1/4"	ISO 6150 B US-MIL-Spec. C4109 Industr. Interchange 1/4"	ISO 6150 B US-MIL-Spec. C4109 Industr. Interchange 1/4"	-	-
Interchange:	Parker Rectus Series 19 PCL60 (UK)	Parker Rectus Series 17 Schrader NW5	Parker Rectus Series 23/24, Hansen 3000, Cejn 310, Milton, Gromelle 600	Parker Rectus Series 23/24, Hansen 3000, Cejn 310, Milton, Gromelle 600	Parker Rectus Series 23/24, Hansen 3000, Cejn 310, Milton, Gromelle 600	Parker Rectus Series 14/22, ARO 210, Cejn 300, Orion 44510, Parker 50	Parker Rectus Series 14/22, ARO 210, Cejn 300, Orion 44510, Parker 50
Area:	Great Britain	Great Britain, Europe	USA, Spain, France	USA, Spain, France	USA, Spain, France	Benelux, Switzerland	Benelux, Switzerland
Page:	86	87	88	90	91	92	93

International Plug Profiles

NEW!

ESOIS
DN 5.5

ESOIG
DN 9

ESK
DN 7.5

ESAC
DN 8

ESACG
DN 10

NEW!

ESSCIG
DN 10

F1K
DN 8

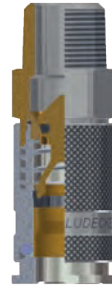
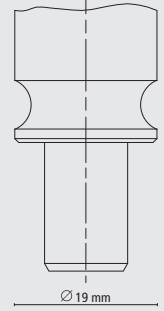
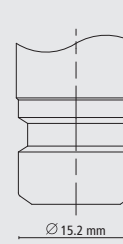
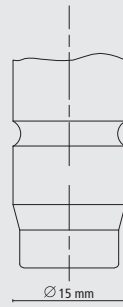
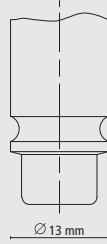
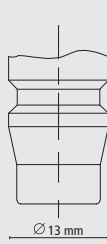
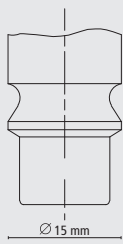
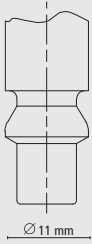

MS 58 nickel-plated Steel hardened + nickel-pl.	MS 58 plain MS 58 plain	MS 58 plain MS 58 nickel-pl.	MS 58 nickel-plated Steel hardened + nickel-pl.	MS 58 nickel-plated Steel hardened + nickel-pl.	MS 58 nickel-plated MS 58 nickel-plated	Steel zinc-pl.+yellow pass. Steel zinc-pl.+yellow pass.
MS 58 nickel-plated MS 58 plain	MS 58 plain MS 58 plain	MS 58 plain MS 58 plain	Steel hardened + zinc-pl. MS 58 plain	Steel zinc-plated MS 58 plain	MS 58 nickel-plated MS 58 plain	Steel zinc-pl.+yellow pass. MS 58 plain
Stainless Steel 1.4310 Stainless Steel 1.4034	Stainless Steel 1.4310 -	Stainless Steel 1.4310 -	Stainless Steel 1.4310 Stainless Steel 1.4034	Stainless Steel 1.4310 Stainless Steel 1.4034	Stainless Steel 1.4310 Stainless Steel 1.4034	Stainless Steel 1.4310 Stainless Steel 1.4034
-	Stainless Steel 1.4305	Stainless Steel 1.4305	-	-	-	-
NBR	NBR	NBR	NBR	NBR	NBR	NBR
EPDM/ FKM/ FFKM	EPDM/ FKM/ FFKM	EPDM/ FKM/ FFKM	EPDM/ FKM/ FFKM	EPDM/ FKM	EPDM/ FKM	EPDM/ FKM/ FFKM
Steel hardened + nickel-plated	Steel hardened + nickel-plated	Steel hardened + nickel-plated	Steel hardened + zinc-plated	Steel hardened + nickel-plated	Steel nickel-plated	Steel zinc-plated + yellow passivated
PN 12 bar -20°C – +100°C	PN 35 bar -20°C – +100°C	PN 35 bar -20°C – +100°C	PN 35 bar -20°C – +100°C	PN 35 bar -20°C – +100°C	PN 35 bar -20°C – +100°C	PN 35 bar -20°C – +100°C
ISO 228/ DIN EN 10226	ISO 228/ DIN EN 10226	ISO 228/ DIN EN 10226	ISO 228/ DIN EN 10226	ISO 228/ DIN EN 10226	ISO 228/ DIN EN 10226	ISO 228
1140 l/min	1400 l/min	1375 l/min	1650 l/min	2600 l/min	2900 l/min	1800 l/min
single One-Hand	single One-Hand	single One-Hand	single One-Hand	single One-Hand	single/double One-Hand/ Two-Hands	single Two-Hands
-	-	-	-	-	-	-
Parker Rectus Series 14/22, ARO 210, Cejn 300, Orion 44510, Parker 50	Rectus Series 40 KA, ARO 310, Orion 44520, Orion 44530	Parker Rectus Series 13/03, Nitto Kohki 200 Cejn 314/315	Parker Rectus Series 33 Atlas Copco QIC 10	Parker Rectus Series 34 KA, Atlas Copco QIC 15	Parker Rectus Series 32, Cejn 408, Tema 1800 SF	-
Benelux, Switzerland	Benelux, Switzerland	especially Asia	worldwide	worldwide	Scandinavia	worldwide
94	95	96	97	98	99	101

Steel zinc-pl. + yellow pass. = Steel zinc-plated and yellow passivated