

Quick Connect Couplings with International Plug Profiles



The **LUDECKE** product range contains a large selection of quick connect couplings with international plug profiles. They cover the world's most common used plug profiles and ensure high compatibility. These coupling systems are available from DN 5 to DN 10 - depending on requested flow rates.

LUDECKE offers quick connect couplings customised to the following countries:

- Great Britain
- Spain
- France
- Benelux countries
- Switzerland
- Asia
- USA
- and others



All series are available in different sizes, connection types, valve types and materials.

Different Sizes and Versions

For better understanding, products with international plug profiles are divided into groups according to country compatibility. However, it is also possible to break them down into the series **Quality-**, **OptiFlow-** and **SafeConnect-Line**.



Quality-Line
Standard Quick Connect Couplings
→ In series ESA DN 5.5 / ESO DN 5.5 / ESK DN 7.5 / F1K DN 8

OptiFlow-Line
Energy-Efficient Quick Connect Couplings with patented OptiFlow by **LUDECKE**® Valve Technology
→ In series ESB DN 5.5 / ESBI DN 5 / ESAI DN 5.5 / ESAIS DN 5.5 / ESOI DN 5.5 / ESOIS DN 5.5 / ESAC DN 8 / ESACG DN 10

SafeConnect-Line
Quick Connect Couplings for High-Safety Standards
→ In series ESAIS DN 5.5 / ESOIS DN 5.5

Chart of Flow Rates

The flow rates of the different coupling systems are summarized in the following chart.

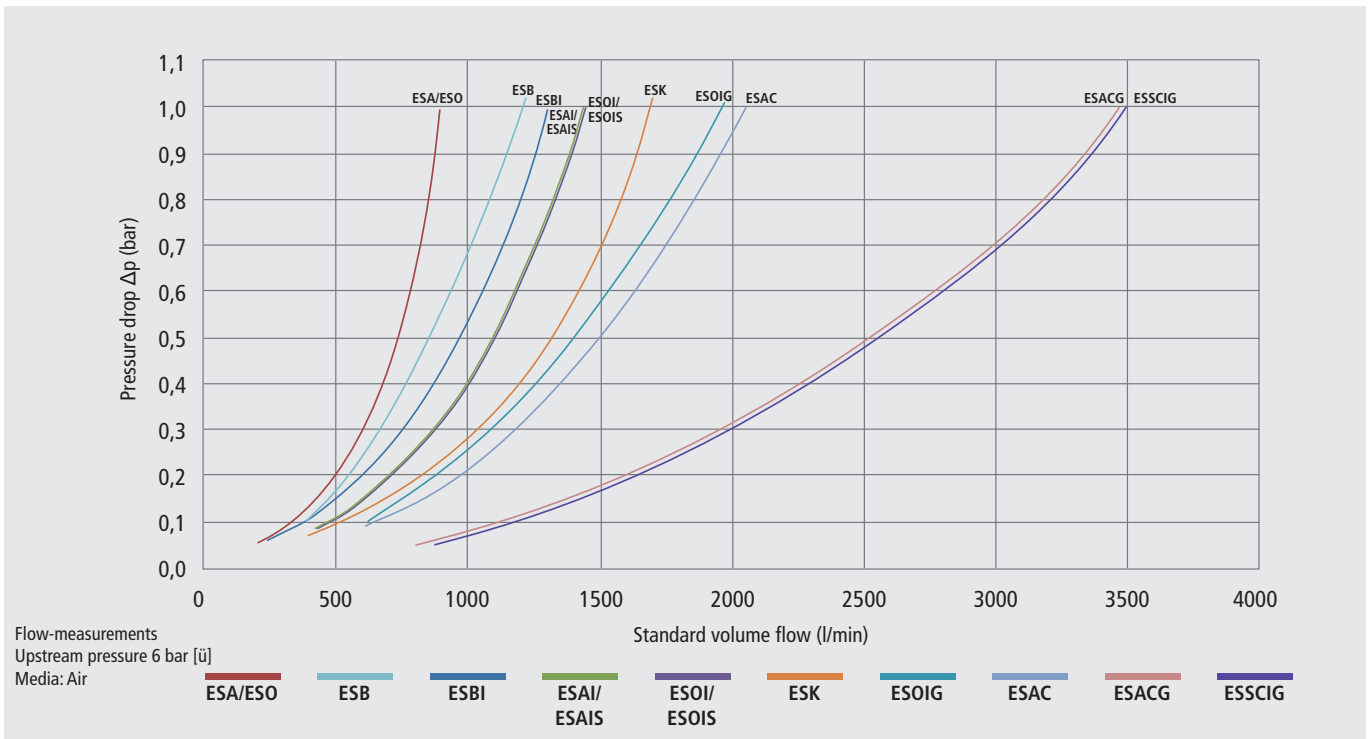

Overview of Quick Connect Couplings with

NEW!

Series **ESB** DN 5.5 **ESBI** DN 5 **ESA** DN 5.5 **ESAI** DN 5.5 **ESAIS** DN 5.5 **ESO** DN 5.5 **ESOI** DN 5.5

Plug Profile
(original size)

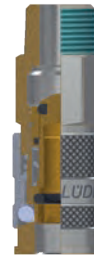
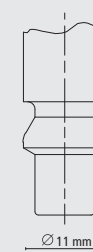
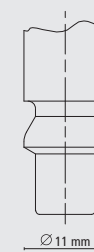
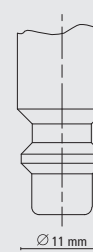
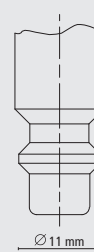
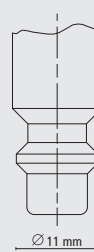
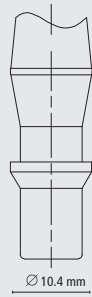

| Materials | ESB DN 5.5 | ESBI DN 5 | ESA DN 5.5 | ESAI DN 5.5 | ESAIS DN 5.5 | ESO DN 5.5 | ESOI DN 5.5 |
|---|--|--|---|---|---|---|---|
| Body: | MS 58 nickel-plated | MS 58 nickel-pl. | MS 58 plain | MS 58 nickel-pl. | MS 58 nickel-pl. | MS 58 plain | MS 58 nickel-pl. |
| Sleeve: | Steel hardened + nickel-pl | Steel hardened + nickel-pl. | MS 58 plain | Steel hardened + nickel-pl. | Steel hardened + nickel-pl. | MS 58 plain | Steel hardened + nickel-pl. |
| Valve body: | MS 58 nickel-plated | Steel hardened + zinc-pl | MS 58 plain | MS 58 nickel-plated | MS 58 nickel-plated | MS 58 plain | MS 58 nickel-plated |
| Valve: | MS 58 plain | MS 58 plain | MS 58 plain | MS 58 plain | MS 58 plain | MS 58 plain | MS 58 plain |
| Springs, Retaining ring: | Stainless Steel 1.4310 | Stainless Steel 1.4310 | Stainless Steel 1.4310 | Stainless Steel 1.4310 | Stainless Steel 1.4310 | Stainless Steel 1.4310 | Stainless Steel 1.4310 |
| Balls: | Stainless Steel 1.4034 | Stainless Steel 1.4034 | - | Stainless Steel 1.4034 | Stainless Steel 1.4034 | - | Stainless Steel 1.4034 |
| Pins: | - | - | Stainless Steel 1.4305 | - | - | Stainless Steel 1.4305 | - |
| Seals: | NBR | NBR | NBR | NBR | NBR | NBR | NBR |
| Special seals for other media on request: | - | EPDM/ FKM/ FFKM | EPDM/ FKM/ FFKM | EPDM/ FKM/ FFKM | EPDM/ FKM/ FFKM | EPDM/ FKM/ FFKM | EPDM/ FKM/ FFKM |
| Plug: | Steel hardened + nickel-plated | Steel hardened + nickel-plated | MS 58 plain/ Steel zinc-pl.+ yellow passivated | Steel hardened + nickel-plated | Steel hardened + nickel-plated | MS 58 plain | Steel hardened + nickel-plated |
| Max. Working Pressure: | PN 35 bar | PN 35 bar | PN 35 bar | PN 35 bar | PN 12 bar | PN 35 bar | PN 35 bar |
| Temperature: | -20°C – +100°C | -20°C – +100°C | -20°C – +100°C | -20°C – +100°C | -20°C – +100°C | -20°C – +100°C | -20°C – +100°C |
| Thread type: | ISO 228/ DIN EN 10226 | ISO 228/ DIN EN 10226 | ISO 228/ NPT | ISO 228/ DIN EN 10226 | ISO 228/ DIN EN 10226 | ISO 228 | ISO 228/ DIN EN 10226 |
| Max. Flow Capacity: at 6 bar (ü) and 0.5 bar Pressure drop Single shut-off | 800 l/min | 950 l/min | 775 l/min | 1100 l/min | 1100 l/min | 775 l/min | 1140 l/min |
| Type of valve: | single | single | single | single | single | single | single |
| Operation: | One-Hand | One-Hand | One-Hand | One-Hand | One-Hand | One-Hand | One-Hand |
| Norm: | - | - | ISO 6150 B US-MIL-Spec. C4109 Industr. Interchange 1/4" | ISO 6150 B US-MIL-Spec. C4109 Industr. Interchange 1/4" | ISO 6150 B US-MIL-Spec. C4109 Industr. Interchange 1/4" | - | - |
| Interchange: | Parker Rectus Series 19 PCL60 (UK) | Parker Rectus Series 17 Schrader NW5 | Parker Rectus Series 23/24, Hansen 3000, Cejn 310, Milton, Gromelle 600 | Parker Rectus Series 23/24, Hansen 3000, Cejn 310, Milton, Gromelle 600 | Parker Rectus Series 23/24, Hansen 3000, Cejn 310, Milton, Gromelle 600 | Parker Rectus Series 14/22, ARO 210, Cejn 300, Orion 44510, Parker 50 | Parker Rectus Series 14/22, ARO 210, Cejn 300, Orion 44510, Parker 50 |
| Area: | Great Britain | Great Britain, Europe | USA, Spain, France | USA, Spain, France | USA, Spain, France | Benelux, Switzerland | Benelux, Switzerland |
| Page: | 86 | 87 | 88 | 90 | 91 | 92 | 93 |

International Plug Profiles

NEW!

ESOIS
DN 5.5

ESOIG
DN 9

ESK
DN 7.5

ESAC
DN 8

ESACG
DN 10

NEW!

ESSCIG
DN 10

F1K
DN 8

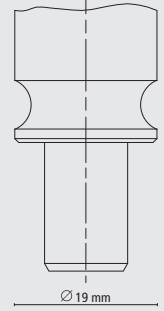
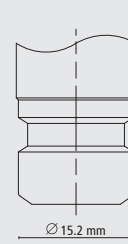
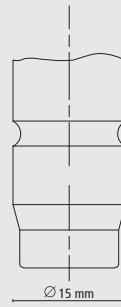
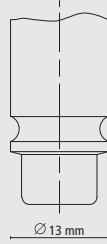
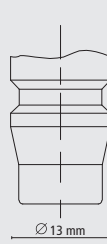
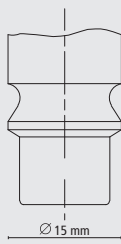
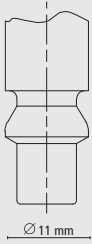

| | | | | | | |
|---|--|--|--|--|---|--|
| MS 58 nickel-plated Steel hardened + nickel-pl. | MS 58 plain MS 58 plain | MS 58 plain MS 58 nickel-pl. | MS 58 nickel-plated Steel hardened + nickel-pl. | MS 58 nickel-plated Steel hardened + nickel-pl. | MS 58 nickel-plated MS 58 nickel-plated | Steel zinc-pl.+yellow pass. Steel zinc-pl.+yellow pass. |
| MS 58 nickel-plated MS 58 plain | MS 58 plain MS 58 plain | MS 58 plain MS 58 plain | Steel hardened + zinc-pl. MS 58 plain | Steel zinc-plated MS 58 plain | MS 58 nickel-plated MS 58 plain | Steel zinc-pl.+yellow pass. MS 58 plain |
| Stainless Steel 1.4310 Stainless Steel 1.4034 | Stainless Steel 1.4310 - | Stainless Steel 1.4310 - | Stainless Steel 1.4310 Stainless Steel 1.4034 | Stainless Steel 1.4310 Stainless Steel 1.4034 | Stainless Steel 1.4310 Stainless Steel 1.4034 | Stainless Steel 1.4310 Stainless Steel 1.4034 |
| - | Stainless Steel 1.4305 | Stainless Steel 1.4305 | - | - | - | - |
| NBR | NBR | NBR | NBR | NBR | NBR | NBR |
| EPDM/ FKM/ FFKM | EPDM/ FKM/ FFKM | EPDM/ FKM/ FFKM | EPDM/ FKM/ FFKM | EPDM/ FKM | EPDM/ FKM | EPDM/ FKM/ FFKM |
| Steel hardened + nickel-plated | Steel hardened + nickel-plated | Steel hardened + nickel-plated | Steel hardened + zinc-plated | Steel hardened + nickel-plated | Steel nickel-plated | Steel zinc-plated + yellow passivated |
| PN 12 bar -20°C – +100°C | PN 35 bar -20°C – +100°C | PN 35 bar -20°C – +100°C | PN 35 bar -20°C – +100°C | PN 35 bar -20°C – +100°C | PN 35 bar -20°C – +100°C | PN 35 bar -20°C – +100°C |
| ISO 228/ DIN EN 10226 | ISO 228/ DIN EN 10226 | ISO 228/ DIN EN 10226 | ISO 228/ DIN EN 10226 | ISO 228/ DIN EN 10226 | ISO 228/ DIN EN 10226 | ISO 228 |
| 1140 l/min | 1400 l/min | 1375 l/min | 1650 l/min | 2600 l/min | 2900 l/min | 1800 l/min |
| single One-Hand | single One-Hand | single One-Hand | single One-Hand | single One-Hand | single/double One-Hand/ Two-Hands | single Two-Hands |
| - | - | - | - | - | - | - |
| Parker Rectus Series 14/22, ARO 210, Cejn 300, Orion 44510, Parker 50 | Rectus Series 40 KA, ARO 310, Orion 44520, Orion 44530 | Parker Rectus Series 13/03, Nitto Kohki 200 Cejn 314/315 | Parker Rectus Series 33 Atlas Copco QIC 10 | Parker Rectus Series 34 KA, Atlas Copco QIC 15 | Parker Rectus Series 32, Cejn 408, Tema 1800 SF | - |
| Benelux, Switzerland | Benelux, Switzerland | especially Asia | worldwide | worldwide | Scandinavia | worldwide |
| 94 | 95 | 96 | 97 | 98 | 99 | 101 |

Steel zinc-pl. + yellow pass. = Steel zinc-plated and yellow passivated